

Circular Saw

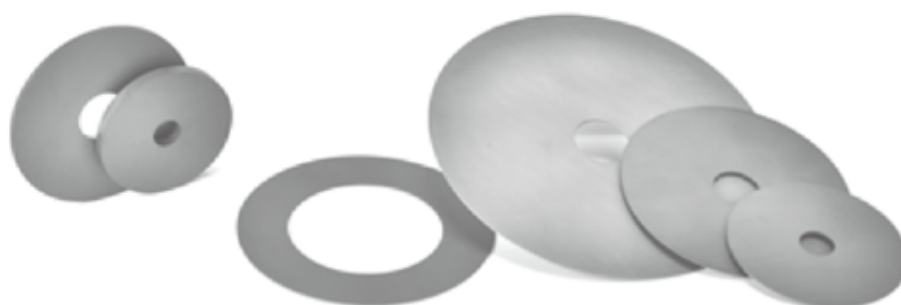

Turning
Inserts



Threading
Inserts
Parting &
Grooving
Inserts



Milling
Inserts



Woodworking
Inserts



Drilling
Inserts



Circular
Saw



Carbide
Flats



Carbide
Saw Tips

Circular Saw

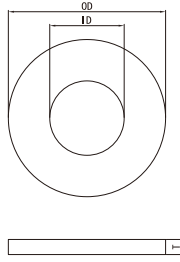

Turning Inserts



Threading Inserts Parting & Grooving Inserts



Milling Inserts



Woodworking Inserts



Drilling Inserts



Circular Saw



Carbide Flats



Carbide Saw Tips

Style	Specification	Dimension (mm)						GU20
		OD	Tol.	ID	Tol.	T	Tol.	
C01604H	C16×4×H	16	(+1.1,+1.2)	4	(-0.5,-0.75)	0.8~10	(+0.2,+0.35)	•
C01605H	C16×5×H	16	(+1.1,+1.2)	5	(-0.5,-0.75)	0.8~10	(+0.2,+0.35)	•
C01606H	C16×6×H	16	(+1.1,+1.2)	6	(-0.5,-0.75)	0.8~10	(+0.2,+0.35)	•
C01608H	C16×8×H	16	(+1.1,+1.2)	8	(-0.5,-0.75)	0.8~10	(+0.2,+0.35)	•
C02005H	C20×5×H	20	(+1.1,+1.3)	5	(-0.5,-0.75)	0.8~10	(+0.2,+0.35)	•
C02505H	C25×5×H	25	(+1.1,+1.3)	5	(-0.5,-0.75)	0.8~10	(+0.2,+0.35)	•
C02506H	C25×6×H	25	(+1.1,+1.3)	6	(-0.5,-0.75)	0.8~10	(+0.2,+0.35)	•
C02508H	C25×8×H	25	(+1.1,+1.3)	8	(-0.5,-0.75)	0.8~10	(+0.2,+0.35)	•
C02510H	C25×10×H	25	(+1.1,+1.3)	10	(-0.5,-0.75)	0.8~10	(+0.2,+0.35)	•
C03006H	C30×6×H	30	(+1.1,+1.3)	6	(-0.5,-0.75)	0.8~10	(+0.2,+0.35)	•
C03008H	C30×8×H	30	(+1.1,+1.3)	8	(-0.5,-0.75)	0.8~10	(+0.2,+0.35)	•
C03012H	C30×12.7×H	30	(+1.1,+1.3)	12.7	(-0.5,-0.75)	0.8~10	(+0.2,+0.35)	•
C03208H	C32×8×H	32	(+1.1,+1.3)	8	(-0.5,-0.85)	0.8~10	(+0.2,+0.35)	•
C04008H	C40×8×H	40	(+1.1,+1.6)	8	(-0.5,-0.95)	0.8~10	(+0.2,+0.35)	•
C04010H	C40×10×H	40	(+1.1,+1.6)	10	(-0.5,-0.95)	0.8~10	(+0.2,+0.35)	•
C04013H	C40×13×H	40	(+1.1,+1.6)	13	(-0.5,-0.95)	0.8~10	(+0.2,+0.35)	•

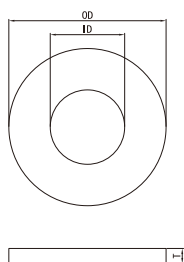

Style	Specification	Dimension (mm)						GU20
		OD	Tol.	ID	Tol.	T	Tol.	
C04016H	C40×16×H	40	(+1.1,+1.6)	16	(-0.5,-0.95)	0.8~10	(+0.2,+0.35)	•
C05008H	C50×8×H	50	(+1.1,+1.7)	8	(-0.5,-0.95)	0.8~10	(+0.2,+0.35)	•
C05010H	C50×10×H	50	(+1.1,+1.7)	10	(-0.5,-0.95)	0.8~10	(+0.2,+0.35)	•
C05012H	C50×12×H	50	(+1.1,+1.7)	12.7	(-0.5,-0.95)	0.8~10	(+0.2,+0.35)	•
C05013H	C50×13×H	50	(+1.1,+1.7)	13	(-0.5,-0.95)	0.8~10	(+0.2,+0.35)	•
C05016H	C50×16×H	50	(+1.1,+1.7)	16	(-0.5,-0.95)	0.8~10	(+0.2,+0.35)	•
C05510H	C55×10×H	55	(+1.1,+1.7)	10	(-0.5,-0.95)	0.8~10	(+0.2,+0.35)	•
C05513H	C55×13×H	55	(+1.1,+1.7)	13	(-0.5,-0.95)	0.8~10	(+0.2,+0.35)	•
C05516H	C55×16×H	55	(+1.1,+1.7)	16	(-0.5,-0.95)	0.8~10	(+0.2,+0.35)	•
C06010H	C60×10×H	60	(+1.1,+1.7)	10	(-0.5,-0.95)	0.8~10	(+0.2,+0.35)	•
C06013H	C60×13×H	60	(+1.1,+1.7)	13	(-0.5,-0.95)	0.8~10	(+0.2,+0.35)	•
C06016H	C60×16×H	60	(+1.1,+1.7)	16	(-0.5,-0.95)	0.8~10	(+0.2,+0.35)	•
C06022H	C60×22×H	60	(+1.1,+1.7)	22	(-0.5,-0.95)	0.8~10	(+0.2,+0.35)	•
C06310H	C63×10×H	63	(+1.1,+1.8)	10	(-0.5,-0.95)	0.8~10	(+0.2,+0.35)	•
C06313H	C63×13×H	63	(+1.1,+1.8)	13	(-0.5,-0.95)	0.8~10	(+0.2,+0.35)	•
C06316H	C63×16×H	63	(+1.1,+1.8)	16	(-0.5,-0.95)	0.8~10	(+0.2,+0.35)	•



Carbide Cutting Tool Blanks

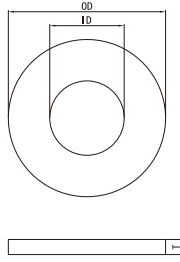

Style	Specification	Dimension (mm)						GU20
		OD	Tol.	ID	Tol.	T	Tol.	
C07012H	C70×12.7×H	70	(+1.1,+1.9)	12.7	(-0.5,-0.95)	0.8~10	(+0.2,+0.35)	•
C07016H	C70×16×H	70	(+1.1,+1.9)	16	(-0.5,-0.95)	0.8~10	(+0.2,+0.35)	•
C07022H	C70×22×H	70	(+1.1,+1.9)	22	(-0.5,-0.95)	0.8~10	(+0.2,+0.35)	•
C07025H	C70×25.4×H	70	(+1.1,+1.9)	25.4	(-0.5,-0.95)	0.8~10	(+0.2,+0.35)	•
C07516H	C75×16×H	75	(+1.1,+1.9)	16	(-0.5,-0.95)	0.8~10	(+0.2,+0.35)	•
C08016H	C80×16×H	80	(+1.1,+2.0)	16	(-0.5,-0.95)	0.8~10	(+0.2,+0.35)	•
C08022H	C80×22×H	80	(+1.1,+2.0)	22	(-0.5,-0.95)	0.8~10	(+0.2,+0.35)	•
C08025H	C80×25.4×H	80	(+1.1,+2.0)	25.4	(-0.5,-0.95)	0.8~10	(+0.2,+0.35)	•
C08516H	C85×16×H	85	(+1.1,+2.0)	16	(-0.5,-0.95)	0.8~10	(+0.2,+0.35)	•
C08532H	C85×32×H	85	(+1.1,+2.0)	32	(-0.5,-0.95)	0.8~10	(+0.2,+0.35)	•
C09016H	C90×16×H	90	(+1.1,+2.0)	16	(-0.5,-0.95)	0.8~10	(+0.2,+0.35)	•
C09022H	C90×22×H	90	(+1.1,+2.0)	22	(-0.5,-0.95)	0.8~10	(+0.2,+0.35)	•
C09025H	C90×25.4×H	90	(+1.1,+2.0)	25.4	(-0.5,-0.95)	0.8~10	(+0.2,+0.35)	•
C10022H	C100×22×H	100	(+1.1,+2.2)	22	(-0.5,-0.95)	0.8~10	(+0.2,+0.35)	•
C10025H	C100×25.4×H	100	(+1.1,+2.2)	25.4	(-0.5,-0.95)	0.8~10	(+0.2,+0.35)	•
C10027H	C100×27×H	100	(+1.1,+2.2)	27	(-0.5,-0.95)	0.8~10	(+0.2,+0.35)	•



Turning Inserts



Threading Inserts Parting & Grooving Inserts



Milling Inserts



Woodworking Inserts



Drilling Inserts



Circular Saw



Carbide Flats



Carbide Saw Tips

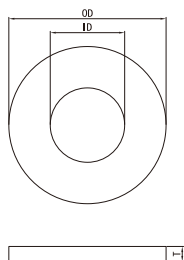

Style	Specification	Dimension (mm)						GU20
		OD	Tol.	ID	Tol.	T	Tol.	
C12522H	C125×22×H	125	(+1.1,+2.8)	22	(-0.5,-0.95)	0.8~10	(+0.2,+0.45)	•
C12575H	C125×75×H	125	(+1.1,+2.8)	75.5	(-0.5,-0.95)	0.8~10	(+0.2,+0.45)	•
C15022H	C150×22×H	150	(+1.1,+2.8)	22	(-0.5,-1.0)	0.8~10	(+0.2,+0.45)	
C15025H	C150×25.4×H	150	(+1.1,+2.8)	25.4	(-0.5,-1.0)	0.8~10	(+0.2,+0.45)	•
C15032H	C150×32×H	150	(+1.1,+2.8)	32	(-0.5,-1.0)	0.8~10	(+0.2,+0.45)	•
C16022H	C160×22×H	160	(+1.1,+3.2)	22	(-0.5,-1.0)	0.8~10	(+0.2,+0.45)	
C16025H	C160×25.4×H	160	(+1.1,+3.2)	25.4	(-0.5,-1.0)	0.8~10	(+0.2,+0.45)	•
C16032H	C160×32×H	160	(+1.1,+3.2)	32	(-0.5,-1.0)	0.8~10	(+0.2,+0.45)	•

