



Turning  
Inserts



Threading  
Inserts  
Parting &  
Grooving  
Inserts



Milling  
Inserts



Woodworking  
Inserts



Drilling  
Inserts



Circular  
Saw



Carbide  
Flats

# Woodworking Inserts

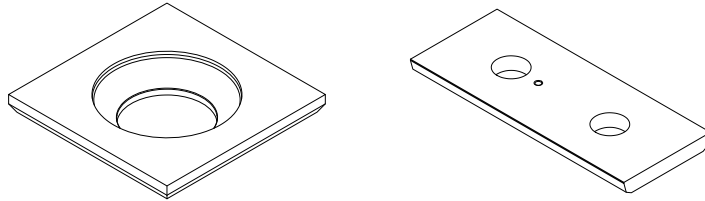

# Woodworking Inserts

## Woodworking Inserts

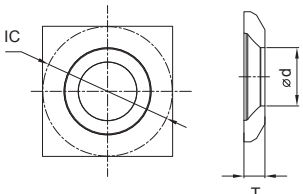
Shape	Style	Dimension (mm)			GEHM Grade
		IC	T	d	GU10UF
SGMB 	SGMB140200	14.00	2.00	6.40	•
	SGMB150250	15.00	2.50	6.50	•



Turning Inserts



Threading Inserts  
Parting & Grooving Inserts



Milling Inserts



Woodworking Inserts



Drilling Inserts



Circular Saw



Carbide Flats

## Woodworking Inserts

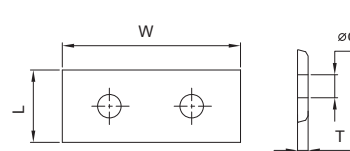
Shape	Style	Dimension (mm)			GEHM Grade
		L	W	T	GU10UF
LOMB 	LOMB300200	30.00	12.00	1.50	•