



Turning
Inserts



Threading
Inserts
Parting &
Grooving
Inserts



Milling
Inserts



Woodworking
Inserts



Drilling
Inserts



Circular
Saw



Carbide
Flats

Drilling Inserts

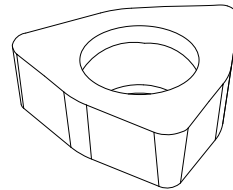
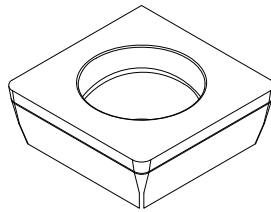
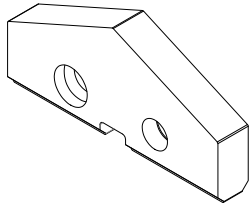

Drilling Inserts

Drilling Inserts

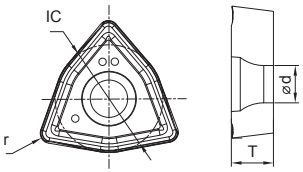
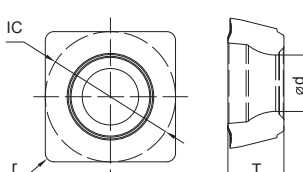
Shape	Style	Dimension (mm)				GEHM Grade
		IC	T	d	r	GU20
	WCSX030208	5.56	2.38	2.80	0.8	•
	WCSX040208	6.35	2.38	3.10	0.8	•
	WCSX050308	7.94	3.38	3.20	0.8	•
	WCSX06T308	9.525	4.17	3.70	0.8	•
	WCSX080412	12.70	4.96	4.30	1.2	•
	SPRG050204	5.56	2.38	2.40	0.4	•
	SPRG060204	6.35	2.38	2.60	0.4	•
	SPRG07T308	7.94	3.97	2.80	0.8	•
	SPRG090408	9.525	4.76	4.00	0.8	•
	SPRG110408	11.11	4.76	4.40	0.8	•
	SPRG140512	14.29	4.76	5.76	1.2	•

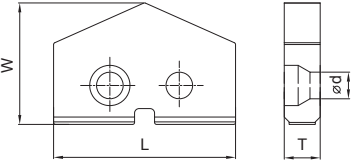

Spade Drill

Shape	Style	Dimension (mm)				GEHM Grade
		L	W	T	d	GU20
	SDB131002	13.46	10.03	2.76	2.26	•
	SDB181203	18.03	12.04	3.56	2.64	•
	SDB241404	24.77	14.99	4.32	3.3	•
	SDB351705	35.43	17.27	5.13	4.29	•
	SDB482106	48.26	21.49	6.73	5.54	•



Turning Inserts



Threading Inserts
Parting &
Grooving Inserts



Milling Inserts



Woodworking Inserts



Drilling Inserts



Circular Saw



Carbide Flats